

PURIKOR



CLASSIC SERIES

UV LIGHT DISINFECTION SYSTEM

V1.1
20/03/2025

INSTALLATION MANUAL

Copyright © 2025 PURIKOR®

The information contained in this document may change without notice.

Abstract

Thank you for your preference when purchasing our PURIKOR CLASSIC series UV light disinfection system.

With the help of this instruction manual you will be able to carry out a correct installation and keep your product in optimal operation, which is why we recommend that you follow the instructions included here.

Keep this manual in a safe place for future reference.

Table of Contents

1. INTRODUCTION	4
2. SAFETY WARNINGS	4
3. PRODUCT PARTS	5
4. TECHNICAL SPECIFICATIONS	6
5. INSTALLATION	7
6. OPERATION AND MAINTENANCE	11
7. SOLUTION OF POSSIBLE FAULTS	12
8. WARRANTY	13

1. INTRODUCTION

This PURIKOR product uses advanced techniques to purify water with ultraviolet light to deliver healthy water. The central part of this system is the ultraviolet light emitting focus.

2. SAFETY WARNINGS



CAUTION

- The ballast must be connected to physical ground.
- Ultraviolet light is not visible to the human eye, but it can damage the eyes and skin. Never see the emitting bulb light directly while it is turned on. Do not remove the emitter bulb from the stainless steel camera with the electrical current turned on. If it is necessary to see the emitting bulb turned on, it is necessary to wear safety glasses.
- It is always important to exercise caution to avoid risks of receiving electric shocks or causing fire. It is recommended that a separate thermal pad be placed to protect the water purifier's power supply with ultraviolet light
- Avoid touching the stainless steel camera or the emitter bulb when it is turned on or minutes after disconnecting it as you can burn your hands. If you need to do so, wear protective gloves

3. PRODUCT PARTS

1. Stainless steel chamber
2. Quartz sleeve
3. O-ring
4. O-ring
5. Stainless steel inlet cap for quartz sleeve
6. Closed stainless steel lid
7. UV emitter bulb
8. 4-pin ballast connector
9. Screw hole
10. Cover
11. Ground connector
12. Electronic ballast (not indicated in the drawing)
13. Lamp holders (not indicated in the drawing)
14. Spring

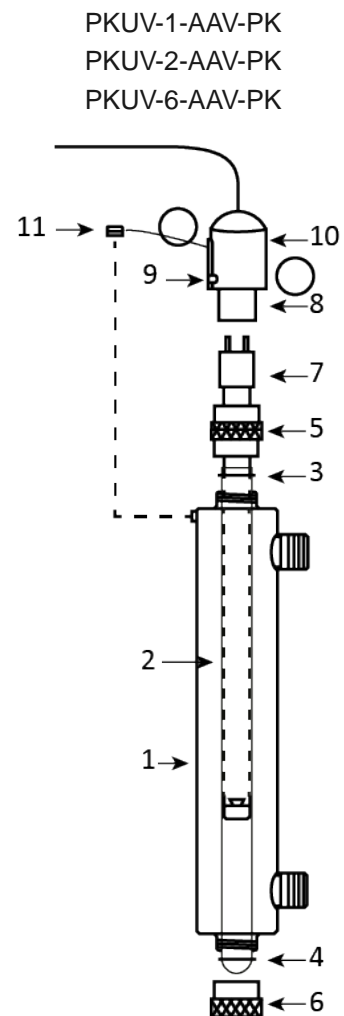
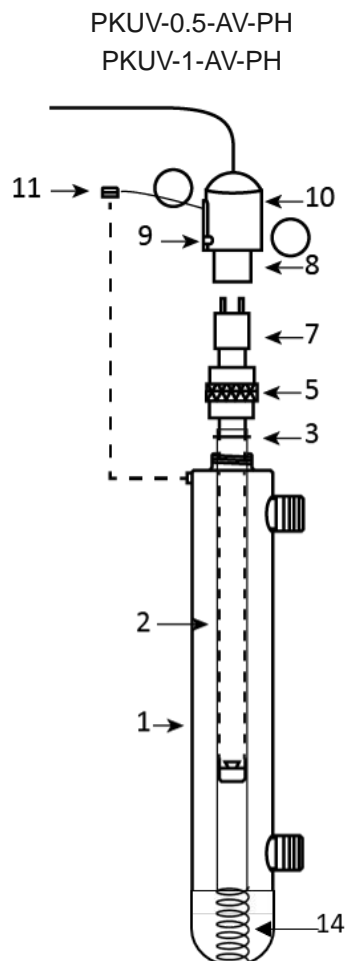

4. TECHNICAL SPECIFICATIONS

Application: For purifying water, food, medicinal and industrial processes.

UV System Model	PKUV-0.5-AV-PH	PKUV-1-AV-PH	PKUV-1-AAV-PK	PKUV-2-AAV-PK	PKUV-6-AAV-PK
CAPACITY	0.5 GPM	1 GPM		2 GPM	6 GPM
INPUT VOLTAGE	127 Vac/60Hz		110 Vac/60 Hz		
EMITTING BULB	6W	11 W	12 W	16 W	25 W
ENERGY CONSUMPTION	6W	11 W	16 W	21 W	32 W
INPUT/OUTPUT CONNECTION	1/4" female NPT			1/2" NPT female	1/2" NPT female
STAINLESS STEEL CHAMBER	25.5 cm * 5 cm	31.5 cm* 5 cm	12.20" * 2"	14.76" * 2.48"	23.42" * 2.48"
MAXIMUM OPERATING PRESSURE	80 psi/5.62 kg/cm ² /5.52 bar		145 psi/10.19 kg/cm ² /10 bar		
MAXIMUM CURRENT	0.12 A	0.15 A	0.44 A		

5. INSTALLATION

1. Please open the product and check that all the parts mentioned above are present. In addition, it is important to check that the installation location where the product is to be placed has an electrical connection and water supply as specified and that it is easily accessible to perform maintenance on the product.

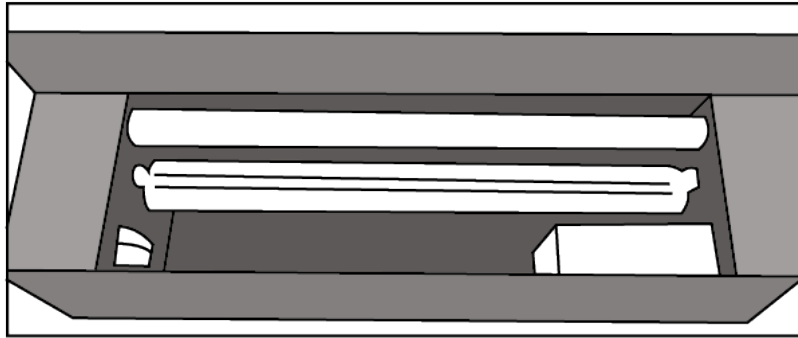

2. Make sure the quartz sleeve and the UV light bulb are clean before installation. If necessary, clean them with alcohol or a mild detergent. Use soft gloves to prevent them from being stained by fingerprints
3. Remove the stainless steel chamber covers.

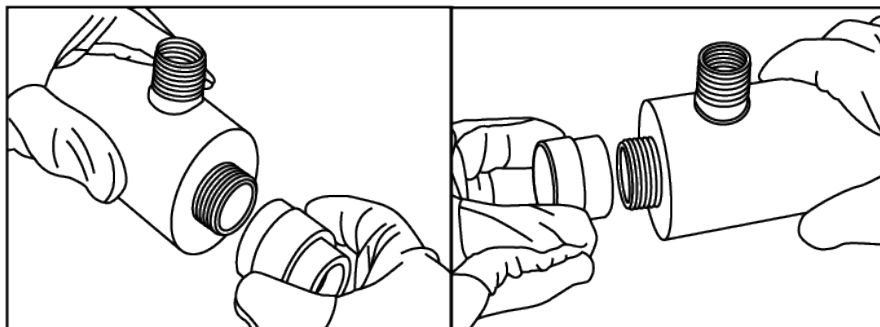

4. Install the O-ring on the open top of the quartz sleeve (0.47 inches from the edge).

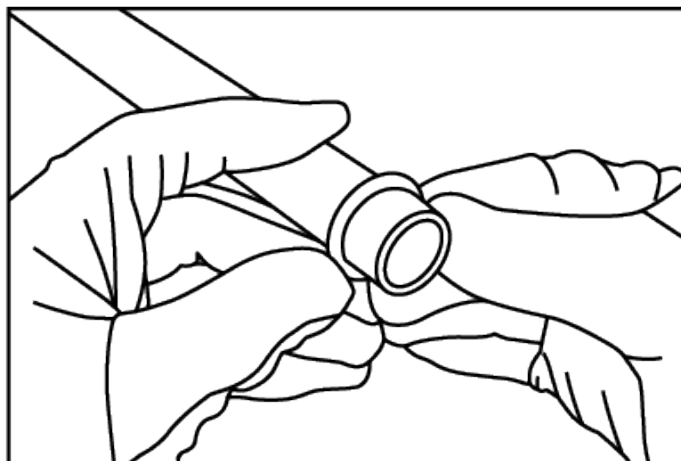

5. Place the quartz sleeve inside the stainless steel chamber.

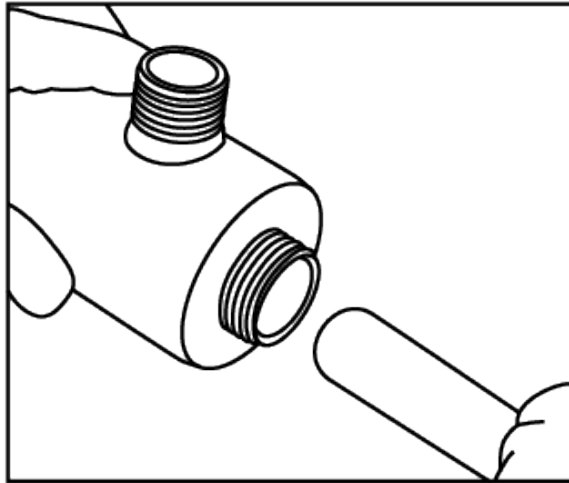

6. At the other end of the steel chamber, place the O-ring in the quartz sleeve.
(For the PKUV-0.5-AVPH and PKUV-1-AVPH models, it has only one end, skip this step).

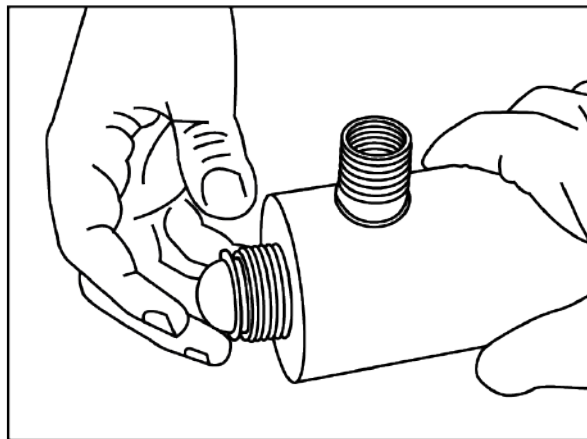

7. Screw on the stainless steel chamber cap. Avoid overtightening the cap to avoid damaging the O-ring or quartz sleeve.

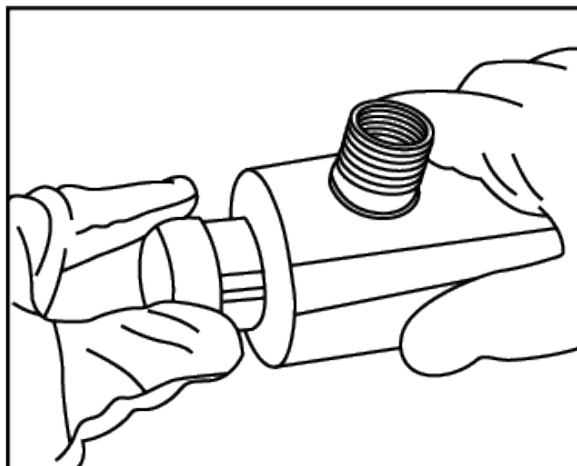

8. Also screw the stainless steel camera cover on the other end. Avoid tightening the cap too tightly so as not to damage the O-ring or quartz sleeve.

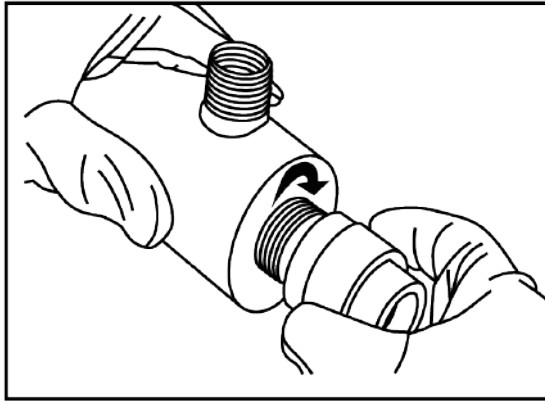

9. Connect the 4-pin UV emitter bulb to the electronic ballast.

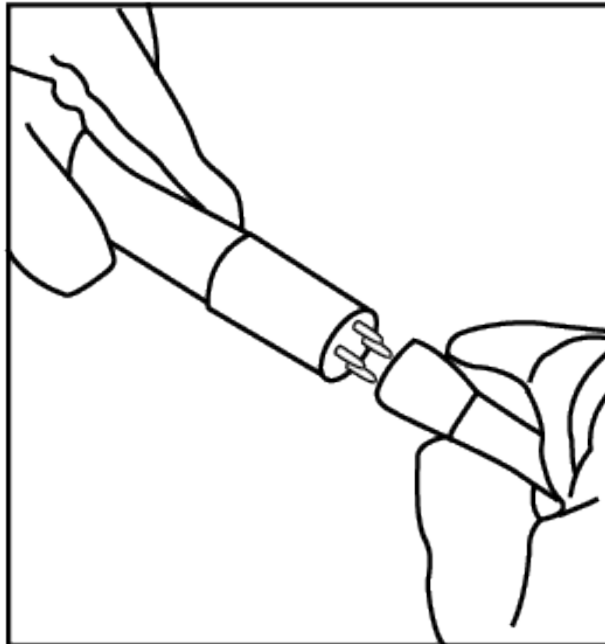

10. Carefully insert the UV emitting bulb into the quartz sleeve through the open cover.

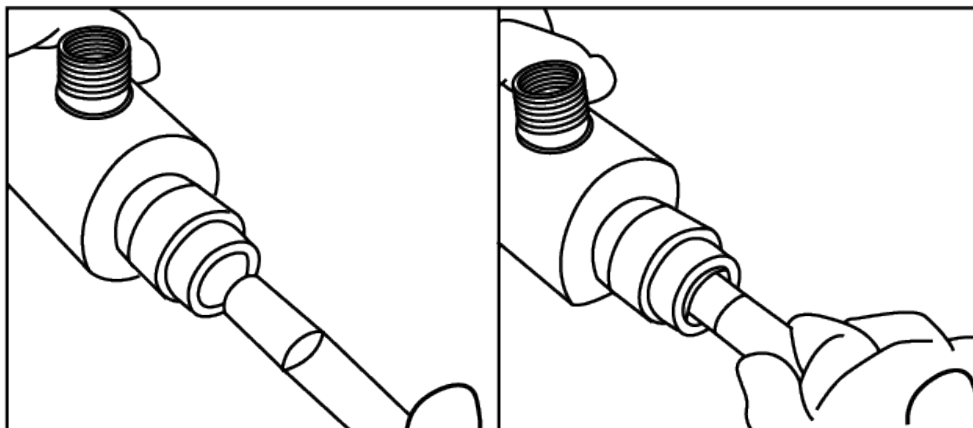

11. Place the plastic cover over the stainless steel chamber lid.

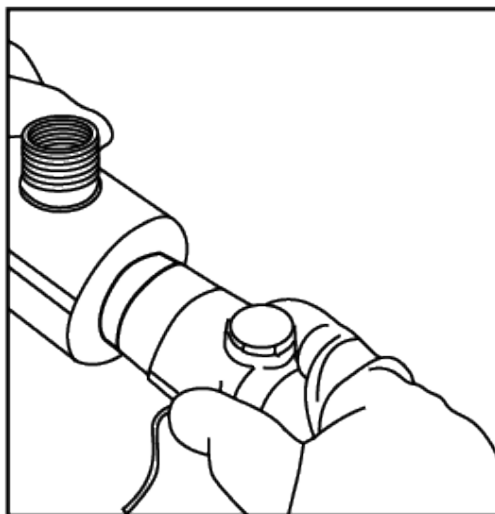

12. The product should be placed as close as possible to the point of use and can be used vertically or horizontally. Make sure the water outlet is always at the top.
13. Make the hydraulic connection of the product. When you are ready, you can open the water valve slowly and check for leaks.
14. Allow the water to run for several minutes so that it is clear and air escapes from the stainless steel chamber.
15. Connect the ballast to the electrical outlet and check that the bulb turns green. If the bulb is red and/or an audible alarm is activated, check the ballast connection to ensure that it is properly installed

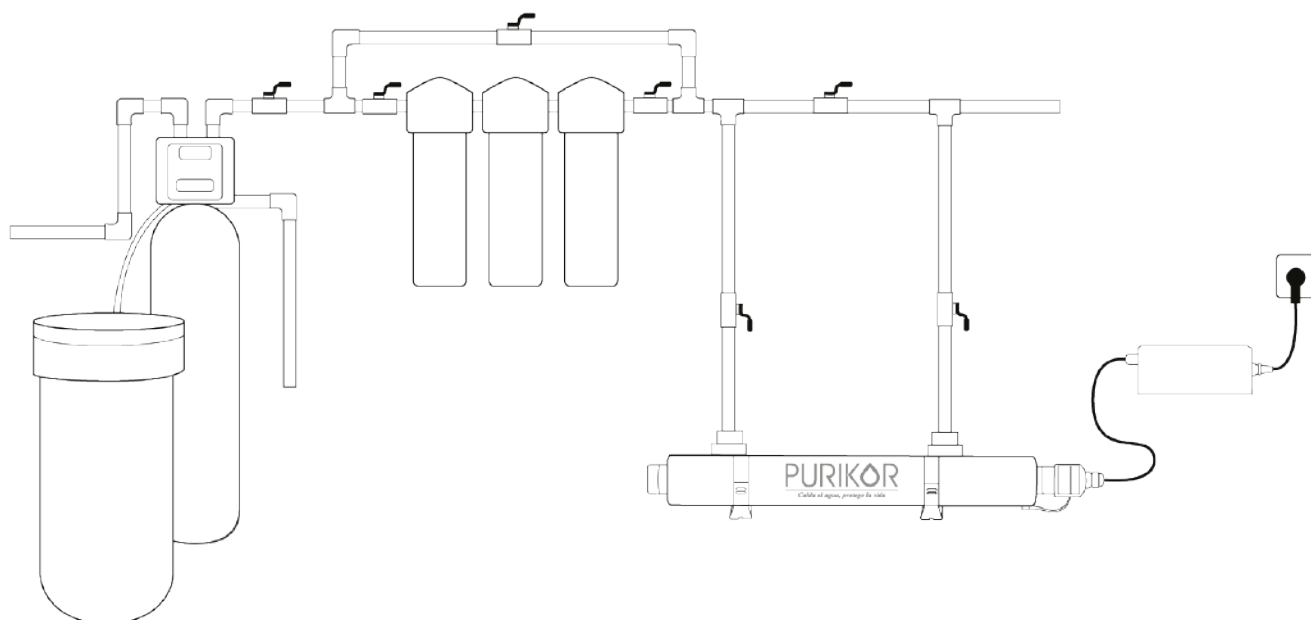

6. OPERATION AND MAINTENANCE

1. Water Quality Guides
 - The purifying product with ultraviolet light is used in clear water, it should not be colored, turbid or cloudy.
 - Ambient water temperature 35.6- 113°F
 - Iron < 0.3 ppm (0.3 mg/l)
 - Hardness < 7 grains per gallon (120mg/l)
 - Turbidity < 1NTU
 - Manganese 0.05ppm (0.05mg/l)
 - Transmittance: > 75%
2. Check the installation before connecting the ballast to electrical power.
3. Do not attempt to install the product if the UV emitting bulb or quartz sleeve is broken. Replace them with a new one before continuing.
4. The water purification system with ultraviolet light is designed for continuous operation. Avoid turning it off and on as this reduces ultraviolet radiation and the lifespan of the emitting bulb
5. If the unit falls into water, immediately turn off the power and then recover it. Do not attempt to use the product if it has been submerged in water.
6. Do not operate the product if the power cord or any of its connections are damaged, if it has been dropped or damaged in any way.
7. The ultraviolet light water purification system should be installed after the filtration product in the water supply line.
8. If the product is at temperatures below the freezing point of water, it is important to disconnect it from the water supply and drain it completely to avoid damage to it.

Maintenance

1. It is important to frequently check that the product is in operation.
2. The UV emitter bulb must be replaced every year. It is important to replace the emitter bulb even though it is still on, as the intensity of ultraviolet light may not be sufficient to ensure adequate water purification
3. It is important to clean the quartz sleeve every 3 to 6 months with alcohol or some detergent so that the quartz does not prevent the passage of UV light. If you have tartar, it is important to remove it with vinegar or with a light acid such as citric acid
4. If the product is not used for a long time, we recommend turning it off and closing the hydraulic water supply.

7. SOLUTION OF POSSIBLE FAULTS

Problem	Possible Cause	Possible Solution
Light indicator and audible alarm off	<ul style="list-style-type: none"> • Disconnected product • There is no electricity • Damaged electrical cable • Damage to power source 	<ul style="list-style-type: none"> • Check for electrical current • Check power supply connection • Reactivate thermals • Replace the power supply
Thermal is constantly disconnected	<ul style="list-style-type: none"> • Bad connection or the connection may be wet • Short circuit in power supply 	<ul style="list-style-type: none"> • Check product connection • Check that the lamp is clean, dry and properly connected • Replace the power supply
Leak in hydraulic connections	<ul style="list-style-type: none"> • Problem in hydraulic connection of the product • Failure of hydraulic material 	<ul style="list-style-type: none"> • Check hydraulic connections • Check O-ring • Connect with Teflon tape
Leak in the stainless steel chamber area	<ul style="list-style-type: none"> • Humidity condensation in the stainless steel chamber • O-ring damage or deterioration • Lamp and sleeve not properly assembled 	<ul style="list-style-type: none"> • Control humidity or relocate product • Check packaging and replace it • Tighten the connections well without overdoing it to avoid damaging product.
Visual and/or Auditory Alarm	<ul style="list-style-type: none"> • Fused focus • Problem connecting to the emitter bulb 	<ul style="list-style-type: none"> • Check electrical connection of product to eliminate alarm • Check electrical current • Review continuity in focus • Replace with a new emitter bulb

8. WARRANTY

With respect PURIKOR POLICIES: PRODUCT of the brand PURIKOR series PURIKOR POLICIES: SERIES, the company offers the following terms:

1. **Length of warranty:** From the PURIKOR POLICIES: WARRANTY YEARS after the billing date.
2. **Warranty conditions:** This applies only to products sold directly by the company to authorized distributors. It does not cover products purchased through other distribution channels. The company will not be responsible for any removal, installation, transportation or any other cost that may be incurred in connection with a warranty claim
3. **Exclusive warranty:** Product guarantees are granted through this certificate. No employee, agent, representative or dealer is authorized to change the terms of this warranty. If the product fails in accordance with the terms of this policy, at the option of the company, you may, without charge in materials or labor, change the product or any of its parts, for the warranty to be effective
4. **Warranty Procedure:** The product must be sent to the company's service center. Additionally, a copy of the purchase invoice and of this warranty policy, duly signed and sealed, must be sent. The costs of shipping to and from the service center are borne by the customer. The company's liability is limited only to the cost of replacing damaged parts. Damages due to delay, use or improper storage of the product are not the company's responsibility. Nor is it responsible for aesthetic or consequential damage generated as a result of the product being discontinued

The company is not responsible for defects attributable to acts, damages or omissions of third parties that occurred after shipment.

The warranty is not applicable under conditions in which, at the company's discretion, the product has been affected in its operation and/or behavior, such as:

- Transport damage.
- Incorrect handling.
- Inadequate installation or application.
- Do not follow the instructions described in the installation manual.
- Excessive operating conditions.
- Unauthorized repairs or modifications.
- Accidental or intentional harm.
- Damage caused by fires, riots, demonstrations or any other act of vandalism, as well as damage caused by natural forces.
- When the shipment of the equipment has been requested and it is not received at the company's home.

Under the conditions of this certificate, the company has the right to inspect any product that has a warranty claim at its service center.

For any other questions or clarifications regarding this warranty certificate or the use of the product, please contact our customer service and service department.

MEXICO: Villarreal Equipment Division, SA de CV Morelos 905 Sur / Allende, NL 67350 Mexico Switch: (826) 26 80 800 Customer service: 01-800-833-50-50 Web site: www.vde.com.mx E-mail: soportetecnico@vde.com.mx	COLOMBIA: ALTAMIRA Water, Ltda. Autopista a Medellin Km. 2.4 Vía Siberia Costado sur Complejo Logístico Industrial y Comercial CLIC 80 Bodega 35 y 36, Cota, Cundinamarca, Colombia Switch: +57-(1)-8219230 Web site: www.altamirawater.com Email: servicio@altamirawater.com
--	--